

**NOTICE!!**

**These documents have been scanned!**

**Do not place un-scanned documents beneath this notice!**

**Do not remove this notice from this file!**

GPO Jacket No. 560-102  
Print Order 61540  
Rise Business Services, LLC  
Job=AZ15 4/30/2019



Box Number= AZ15010



Claim Begin-End: AMC441704-AMC441715

1 Initial Receipt



AZ15010-2

AMC450400-AMC453366



**AMC #****DATE CLOSED****ADJ INITIAL**

REMARKS

[illegible]



United States Department of the Interior  
Bureau of Land Management  
DIV OF LANDS, MINRLS & ENERGY  
ONE N CENTRAL AVE  
PHOENIX, AZ 85004 -4427  
Phone: 602-417-9200

Receipt

No: 3764645

<b>Transaction #:</b> 3870685	
<b>Date of Transaction:</b> 02/15/2017	
CUSTOMER:	
T3 LLC 1111 E 12TH ST HARPER,KS 67058-2407 US	

**ENTERED**  
FEB 16 2017  
BY: *Ram*

LINE #	QTY	DESCRIPTION	REMARKS	UNIT PRICE	TOTAL
1	12.00	LOCATABLE MINERALS / MINING CLAIMS-NEW,UNADJUD, ONE OR MORE AUTH NOS / NEW MINING CLAIM PROCESSING FEE <b>CASES:</b> AMC441704/\$20.00, AMC441705/\$20.00, AMC441706/\$20.00, AMC441707/\$20.00, AMC441708/\$20.00, AMC441709/\$20.00, AMC441710/\$20.00, AMC441711/\$20.00, AMC441712/\$20.00, AMC441713/\$20.00, AMC441714/\$20.00, AMC441715/\$20.00		- n/a -	240.00
2	12.00	LOCATABLE MINERALS / MINING CLAIMS-NEW,UNADJUD, ONE OR MORE AUTH NOS / NEW MINING CLAIMS LOCATION FEE <b>CASES:</b> AMC441704/\$37.00, AMC441705/\$37.00, AMC441706/\$37.00, AMC441707/\$37.00, AMC441708/\$37.00, AMC441709/\$37.00, AMC441710/\$37.00, AMC441711/\$37.00, AMC441712/\$37.00, AMC441713/\$37.00, AMC441714/\$37.00, AMC441715/\$37.00		- n/a -	444.00
3	12.00	LOCATABLE MINERALS / MINING CLAIMS-NEW,UNADJUD, ONE OR MORE AUTH NOS / NEW MINING CLAIMS MAINTENANCE FEE <b>CASES:</b> AMC441704/\$155.00, AMC441705/\$155.00, AMC441706/\$155.00, AMC441707/\$155.00, AMC441708/\$155.00, AMC441709/\$155.00, AMC441710/\$155.00, AMC441711/\$155.00, AMC441712/\$155.00, AMC441713/\$155.00, AMC441714/\$155.00, AMC441715/\$155.00		- n/a -	1860.00
<b>TOTAL:</b>					<b>\$2,544.00</b>



# PAYMENT INFORMATION

NOTE: Items will appear on credit card statement as "Bureau of Land Mgmt CO".

1	AMOUNT:	2544.00	POSTMARKED:	N/A
	TYPE:	CREDIT CARD	RECEIVED:	02/15/2017
	NAME:	T3 LLC 1111 E 12TH ST HARPER KS 67058-2407 US		
	CARD NO:	XXXXXXXXXXXX1223	AUTH CODE:	777730
	NAME ON CARD:	ALVIN L BURCH		
	EXPIRES:	12/2019		
	SIGNATURE:			

## REMARKS

This receipt was generated by the automated BLM Collections and Billing System and is a paper representation of a portion of the official electronic record contained therein.



**NOTICE!!**

**These documents have been scanned!**

**Do not place un-scanned documents beneath this notice!**

**Do not remove this notice from this file!**

GPO Jacket No. 560-102  
Print Order 61540  
Rise Business Services, LLC  
Job=AZ15 4/30/2019



Box Number= AZ15010



Claim Begin-End: AMC441704-AMC441715

2 Correspondence



AZ15010-2

AMC450400-AMC453366



**NO  
DOCUMENTS  
FOUND**

NO DOCUMENTS FOUND  
NO DOCUMENTS FOUND



**NOTICE!!**

**These documents have been scanned!**

**Do not place un-scanned documents beneath this notice!**

**Do not remove this notice from this file!**

GPO Jacket No. 560-102  
Print Order 61540  
Rise Business Services, LLC  
Job=AZ15 4/30/2019



Box Number= AZ15010



Claim Begin-End: AMC441704-AMC441715

3 Transfers



AZ15010-2    AMC450400-AMC453366



**NO  
DOCUMENTS  
FOUND**

NO DOCUMENTS FOUND  
NO DOCUMENTS FOUND



**NOTICE!!**

**These documents have been scanned!**

**Do not place un-scanned documents beneath this notice!**

**Do not remove this notice from this file!**

GPO Jacket No. 560-102  
Print Order 61540  
Rise Business Services, LLC  
Job=AZ15 4/30/2019



Box Number= AZ15010



Claim Begin-End: AMC441704-AMC441715

4 Annual Filings



AZ15010-2

AMC450400-AMC453366



UNITED STATES DEPARTMENT OF THE INTERIOR  
BUREAU OF LAND MANAGEMENT  
One North Central, Suite 800  
Phoenix, AZ 85004

441704

Maintenance Fees

FOR: 2020 (September 1, 2019 – August 31, 2020)

(T3 LLC – Yavapai County, Arizona)

The following describes unpatented mining claims located in Township 10 North, Range 04 West, Section 29, Gila and Salt River Meridian, Yavapai County, State of Arizona, the location notices of which are recorded in the office of the Yavapai County Recorder and filed in the Arizona State Office of the Bureau of Land Management:

Claim Name	AMC Number	Acreage
Golden Cross 1	441704	20
Golden Cross 2	441705	20
Golden Cross 3	441706	20
Golden Cross 4	441707	20
Golden Cross 5	441708	20
Golden Cross 6	441709	20
Golden Cross 7	441710	20
Golden Cross 8	441711	20
Golden Cross 9	441712	20
Golden Cross 10	441713	20
Golden Cross 11	441714	20
Golden Cross 12	441715	20

TOTAL: 12 CLAIMS

Name and Address of Owner or Claimant:

T3 LLC  
1111 East 12th  
Harper, KS 67058

BLM Payment: The annual maintenance fees due to the U.S. Department of the Interior, Bureau of Land Management (BLM), submitted with this document on or before August 31, 2019, have been calculated by multiplying each of the 20-acre claims (12) by \$165, resulting in a total amount due to the BLM, enclosed herewith, of one thousand nine hundred eighty dollars (\$1,980.00).

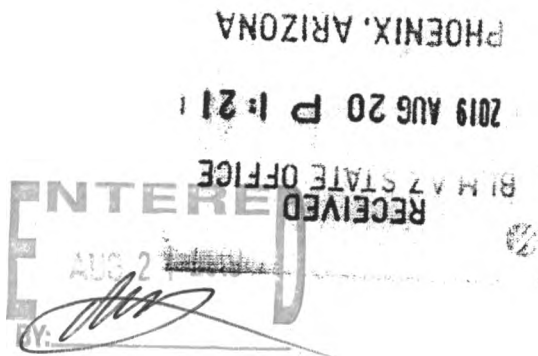

NO. OF CLAIMS 12  
AMOUNT \$1980.  
RECEIPT NO. 4537831  
INIT. [Signature]

\*\* BLM-ASO\*\*

**United States Department of the Interior**  
**Bureau of Land Management**  
DIV OF LANDS, MINRLS & ENERGY  
ONE N CENTRAL AVE  
PHOENIX, AZ 85004 -4427  
Phone: 602-417-9200

Receipt

No: 4537831

<b>Transaction #:</b> 4658747	
<b>Date of Transaction:</b> 08/20/2019	
CUSTOMER:	
	T3 LLC 1111 E 12TH ST HARPER,KS 67058-2407 US

LINE #	QTY	DESCRIPTION	REMARKS	UNIT PRICE	TOTAL
1	1.00	LOCATABLE MINERALS / MINING CLAIMS- NOT NEW-UNADJUD,ONE AUTH NO. ONLY / MINING CLAIM MONEY RECEIVED CASES: AMC441704/\$1980.00	2020 MAINT (12)	- n/a -	1980.00
TOTAL:					\$1,980.00

PAYMENT INFORMATION				
1	AMOUNT:	1980.00	POSTMARKED:	N/A
	TYPE:	CHECK	RECEIVED:	08/20/2019
	CHECK NO:	1313		
	NAME:	TFAC LLC 7426 SE CHIEFTAIN RD PO BOX 111 KIOWA KS 67070 US		

REMARKS

This receipt was generated by the automated BLM Collections and Billing System and is a paper representation of a portion of the official electronic record contained therein.



UNITED STATES DEPARTMENT OF THE INTERIOR  
BUREAU OF LAND MANAGEMENT  
One North Central, Suite 800  
Phoenix, AZ 85004

441704

Maintenance Fees

FOR: 2019 (September 1, 2018 – August 31, 2019)

(T3 LLC – Yavapai County, Arizona)

The following describes unpatented mining claims located in Township 10 North, Range 04 West, Section 29, Gila and Salt River Meridian, Yavapai County, State of Arizona, the location notices of which are recorded in the office of the Yavapai County Recorder and filed in the Arizona State Office of the Bureau of Land Management:

Claim Name	AMC Number	Acreage
Golden Cross 1	441704	20
Golden Cross 2	441705	20
Golden Cross 3	441706	20
Golden Cross 4	441707	20
Golden Cross 5	441708	20
Golden Cross 6	441709	20
Golden Cross 7	441710	20
Golden Cross 8	441711	20
Golden Cross 9	441712	20
Golden Cross 10	441713	20
Golden Cross 11	441714	20
Golden Cross 12	441715	20

TOTAL: 12 CLAIMS

Name and Address of Owner or Claimant:

T3 LLC  
1111 East 12th  
Harper, KS 67058

BLM Payment: The annual maintenance fees due to the U.S. Department of the Interior, Bureau of Land Management (BLM), submitted with this document on or before August 31, 2018, have been calculated by multiplying each of the 20-acre claims (12) by \$155, resulting in a total amount due to the BLM, enclosed herewith, of one thousand eight hundred sixty dollars (\$1,860.00).

NO. OF CLAIMS 12  
AMOUNT \$1860.00  
RECEIPT NO. 4237007  
INIT. RAM 1  
\*\* BLM-ASO\*\*

ENTERED  
AUG 20 2018  
BY: RAM

RECEIVED  
BLM AZ STATE OFFICE  
2018 AUG 16 P 1:32  
PHOENIX, ARIZONA

**United States Department of the Interior**  
**Bureau of Land Management**  
DIV OF LANDS, MINRLS & ENERGY  
ONE N CENTRAL AVE  
PHOENIX, AZ 85004 -4427  
Phone: 602-417-9200

Receipt

No: 4237007

<b>Transaction #:</b> 4352386	
<b>Date of Transaction:</b> 08/16/2018	
CUSTOMER:	
	T3 LLC 1111 E 12TH ST HARPER,KS 67058-2407 US

LINE #	QTY	DESCRIPTION	REMARKS	UNIT PRICE	TOTAL
1	1.00	LOCATABLE MINERALS / MINING CLAIMS- NOT NEW-UNADJUD,ONE AUTH NO. ONLY / MINING CLAIM MONEY RECEIVED <b>CASES:</b> AMC441704/\$1860.00	2019 MAINT (12)	- n/a -	1860.00
<b>TOTAL:</b>					<b>\$1,860.00</b>

PAYMENT INFORMATION				
1	AMOUNT:	1860.00	POSTMARKED:	N/A
	TYPE:	CHECK	RECEIVED:	08/16/2018
	CHECK NO:	1179		
	NAME:	TFAC LLC 7426 SE CHIEFTAIN RD PO BOX 111 KIOWA KS 67070 US		

REMARKS

This receipt was generated by the automated BLM Collections and Billing System and is a paper representation of a portion of the official electronic record contained therein.



UNITED STATES DEPARTMENT OF THE INTERIOR  
BUREAU OF LAND MANAGEMENT  
One North Central, Suite 800  
Phoenix, AZ 85004

441704

**Maintenance Fees**

FOR: 2018 (September 1, 2017 – August 31, 2018)

(T3 LLC – Yavapai County, Arizona)

The following describes unpatented mining claims located in Township 10 North, Range 04 West, Section 29, Gila and Salt River Meridian, Yavapai County, State of Arizona, the location notices of which are recorded in the office of the Yavapai County Recorder and filed in the Arizona State Office of the Bureau of Land Management:

Claim Name	AMC Number	Acreage
Golden Cross 1	441704	20
Golden Cross 2	441705	20
Golden Cross 3	441706	20
Golden Cross 4	441707	20
Golden Cross 5	441708	20
Golden Cross 6	441709	20
Golden Cross 7	441710	20
Golden Cross 8	441711	20
Golden Cross 9	441712	20
Golden Cross 10	441713	20
Golden Cross 11	441714	20
Golden Cross 12	441715	20

TOTAL: 12 CLAIMS

Name and Address of Owner or Claimant:

T3 LLC  
1111 East 12th  
Harper, KS 67058

BLM Payment: The annual maintenance fees due to the U.S. Department of the Interior, Bureau of Land Management (BLM), submitted with this document on or before August 31, 2017, have been calculated by multiplying each of the 20-acre claims (12) by \$155, resulting in a total amount due to the BLM, enclosed herewith, of one thousand eight hundred sixty dollars (\$1,860.00).

RECEIVED  
BLM AZ STATE OFFICE  
2017 AUG 21 A 11:31  
PHOENIX, ARIZONA

# 3946558





**United States Department of the Interior**  
**Bureau of Land Management**  
DIV OF LANDS, MINRLS & ENERGY  
ONE N CENTRAL AVE  
PHOENIX, AZ 85004 -4427  
Phone: 602-417-9200

Receipt

No: 3946558

<b>Transaction #:</b> 4056264	
<b>Date of Transaction:</b> 08/21/2017	
CUSTOMER:	
	T3 LLC 1111 E 12TH ST HARPER,KS 67058-2407 US

LINE #	QTY	DESCRIPTION	REMARKS	UNIT PRICE	TOTAL
1	1.00	LOCATABLE MINERALS / MINING CLAIMS- NOT NEW-UNADJUD,ONE AUTH NO. ONLY / MINING CLAIM MONEY RECEIVED CASES: AMC441704/\$1860.00	MAINT 2018/12	- n/a -	1860.00
TOTAL:					\$1,860.00

PAYMENT INFORMATION				
1	AMOUNT:	1860.00	POSTMARKED:	N/A
	TYPE:	CHECK	RECEIVED:	08/21/2017
	CHECK NO:	1146		
	NAME:	BURCH CONSULTING SERVICES LLC 4423 E PHELPS RD PHOENIX AZ 85032 US		

REMARKS

This receipt was generated by the automated BLM Collections and Billing System and is a paper representation of a portion of the official electronic record contained therein.



**NOTICE!!**

**These documents have been scanned!**

**Do not place un-scanned documents beneath this notice!**

**Do not remove this notice from this file!**

GPO Jacket No. 560-102

Print Order 61540

Rise Business Services, LLC

Job=AZ15 4/30/2019



Box Number= AZ15010



Claim Begin-End: AMC441704-AMC441715

5 Miscellaneous



AZ15010-2

AMC450400-AMC453366



**NO  
DOCUMENTS  
FOUND**

NO DOCUMENTS FOUND  
NO DOCUMENTS FOUND



**NOTICE!!**

**These documents have been scanned!**

**Do not place un-scanned documents beneath this notice!**

**Do not remove this notice from this file!**

GPO Jacket No. 560-102  
Print Order 61540  
Rise Business Services, LLC  
Job=AZ15 4/30/2019



Box Number= AZ15010



Claim Begin-End: AMC441704-AMC441715

6 Location Notices-Amendments and Supporting Documents



AZ15010-2 AMC450400-AMC453366



# MINING CLAIM STATUS REPORT

Data Entered: 02/16/17 AM

MTP Checked By: PER  
GEO Checked By: PER

LEAD SERIAL NUMBER: AMC 441704 thru AMC 441715

## NUMBER OF CLAIMS & TYPE:

\_\_\_\_ LODGE  
12 PLACER  
\_\_\_\_ ASSOCIATION PLACER  
\_\_\_\_ MILL SITE  
\_\_\_\_ TUNNEL SITE

## CHARGES:

Processing Fee @ \$20 = \$ 240.00  
Location Fee @ \$37 = \$ 444.00  
Maintenance Fee @ \$155 = \$ 1860.00  
Add'l Maint Fee for Assoc Placer = \$ \_\_\_\_\_  
**SUBTOTAL** \$ 2544.00  
Other Fees \$ \_\_\_\_\_  
Other Fees \$ \_\_\_\_\_  
**TOTAL** \$ \_\_\_\_\_

**TOTAL ACREAGE:** 20 Per Claim  
(Placer Only)

**NUMBER OF LOCATORS:** \_\_\_\_\_

**DOCUMENTS RECEIVED VIA :** Over-the-Counter ☒ Mail ☐ **TIMELY FILED:** Yes ☒ No ☐

**LEGAL DESCRIPTION:** T 10N R 4W SEC 29  
T \_\_\_\_\_ R \_\_\_\_\_ SEC \_\_\_\_\_  
T \_\_\_\_\_ R \_\_\_\_\_ SEC \_\_\_\_\_  
T \_\_\_\_\_ R \_\_\_\_\_ SEC \_\_\_\_\_  
T \_\_\_\_\_ R \_\_\_\_\_ SEC \_\_\_\_\_

BLM ☒ FOREST SERVICE ☐ SUBJ TO PL 359: Yes ☐ No ☐  
WILDERNESS AREA ☐

**SPLIT ESTATE:** N/A ☐ SX ☐ PX ☐ OTHER ☐  
SRHA ☐ Was proper Notice filed if located on SHRA Land? Yes ☐ No ☐

## RECONVEYED MINERALS ON BLM LAND REQUIRE OPENING ORDER FROM 1944 TO 1993:

Open to Entry On \_\_\_\_\_ N/A ☐

**COMMENTS/STATUS:** VOID ☐ PARTIALLY VOID ☐ PVT MINERALS ☐ WITHDRAWN LANDS ☐  
OTHER ☐

☐ Claimant acknowledges that portions of the following claim(s) site(s) may be void or voidable.

Printed Name of Claimant \_\_\_\_\_ Signature of Claimant \_\_\_\_\_

\*\*\*\*\*FINAL ADJUDICATION\*\*\*\*\*

DATE 2/23/2018 INITIALS PM

AMC 441704



\* Return To:

**LOCATION NOTICE FOR PLACER MINING CLAIM**

☐ Amendment BLM Serial # \_\_\_\_\_

NOTICE IS HEREBY GIVEN that the Golden Cross 1

\_\_\_\_\_ placer mining claim has been located by

\* T3 LLC whose current mailing

address is 1111 East 12<sup>th</sup>

Harper, Kansas 67058

The general course of this claim is East-West and it is situated in Yavapai County, Arizona. This claim is 1320 feet in length and 660 feet in width.

19.61 Total Claim Acreage. This claim runs from the location monument on which this location notice is posted at the SE corner of the claim approximately 660 feet in a North direction to the North end line and 1320 feet in a West direction to the West end line. This claim is marked by 7 monuments, a location monument and one at each angle on the boundary of the claim.

The location monument on which this notice is posted is situated within Section 29, Township 10 North, Range 4 West, Gila Salt River Base and Meridian, Arizona. This claim encompasses portions of the following legal subdivision(s) if located by legal subdivision or the following quarter section(s), section(s), Township(s) and Range(s) N 1/2 Lot 7, Sec. 29, T.10 N., R.4 W., G&SRM, Gila Salt River Base and Meridian, Arizona.

The locality of this claim with reference to some natural object or permanent monument and additional information

(if any) concerning its locality are as follows: NW Corner of the mining Claim is the West quarter corner of Sec 29

\_\_\_\_\_ The above information is shown on the attached map.

DATED AND POSTED on the ground this 18<sup>th</sup> day of January, 2017.

☒ LOCATOR(s) ☐ AGENT

Print Name(s) NELSON TUCKER STAN TUCKER Brenda Shue

Signature(s) Nelson Tucker Stan Tucker Brenda Shue

Form MCF102  
Revised July 2014

This form is available from the Arizona Geological Survey and may be reproduced.

AMC441704



**MINING CLAIM MAP**  
Lode ( ) Placer (x) Millsite ( )

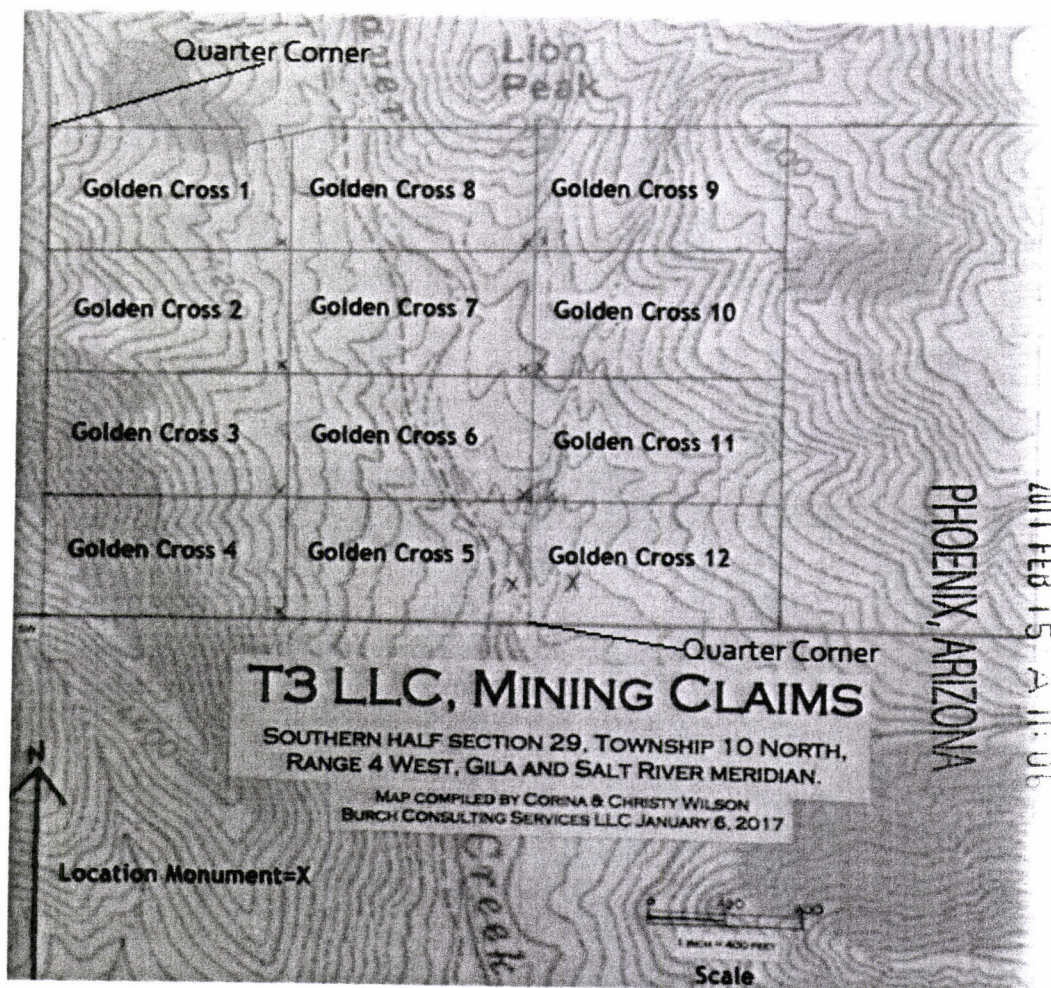

RECEIVED  
BLM AZ STATE OFFICE

PHOENIX, ARIZONA

2017 FEB 15 AM 11:06

AMC441704

1. The above map depicts the Golden Cross 1 mining claim, which is located in Section (s) 29, Township 10 North, Range 4 West, Gila and Salt River Base and Meridian, Yavapai County, Arizona. Total claim acreage is 19.61.
2. The type of corner and location monuments used are as follows: 2" Diameter PVC posts
3. The bearings and distances in degrees and feet between claim corners and to a public land survey monument are as depicted on the map.
4. If the claim is a placer or mill site claim with exterior limits conforming to legal subdivisions of the public survey, provide a legal description of the claim: N 1/2 Lot 7, Sec. 29, T. 10 N., R. 4 W., G & SRM

Form MCF100a  
Revised July 2014

This form is available from the **Arizona Geology Survey** and may be reproduced.



Return to \*

**LOCATION NOTICE FOR PLACER MINING CLAIM**

☐ Amendment BLM Serial # \_\_\_\_\_

NOTICE IS HEREBY GIVEN that the Golden Cross 2

\_\_\_\_\_ placer mining claim has been located by

T3 LLC whose current mailing

\* address is 1111 East 12<sup>th</sup>  
Harper, Kansas 67058

BLM  
Date  
Stamp

PHOENIX, ARIZONA

2017 FEB 15 A 11 00AM

BLM AZ STATE OFFICE

RECEIVED

The general course of this claim is East-West and it is situated in Yavapai  
County, Arizona. This claim is 1320 feet in length and 660 feet in width.

20 Total Claim Acreage. This claim runs from the location monument on which this location notice is  
posted at the SE corner of the claim approximately 660 feet in a North direction to the  
North end line and 1320 feet in a West direction to the West end line. This claim is  
marked by 5 monuments, a location monument and one at each angle on the boundary of the claim.

The location monument on which this notice is posted is situated within Section 29, Township  
10 North Range 4 West, Gila Salt River Base and Meridian, Arizona. This claim encompasses  
portions of the following legal subdivision(s) if located by legal subdivision or the following quarter section(s),  
section(s), Township(s) and Range(s) S 1/2 Lot 7, Sec 29, T.10 N.,  
R. 4 W., Gila Salt River Base and Meridian, Arizona.

The locality of this claim with reference to some natural object or permanent monument and additional information  
(if any) concerning its locality are as follows: NW Corner of the mining claim  
is 660 feet S. 0° 02' E. of the West quarter  
corner of Sec. 29 The above information is shown on the attached map.

DATED AND POSTED on the ground this 18<sup>th</sup> day of January, 20 17.

☒ LOCATOR(s) ☐ AGENT

Print Name(s) NELSON TUCKER

STAN TUCKER

Brenda Shue

Signature(s)

Nelson Tucker

Stan Tucker

Brenda Shue

Form MCF102  
Revised July 2014

This form is available from the Arizona Geological Survey and may be reproduced.

AMC441705



**MINING CLAIM MAP**  
Lode ( ) Placer (✓) Millsite ( )

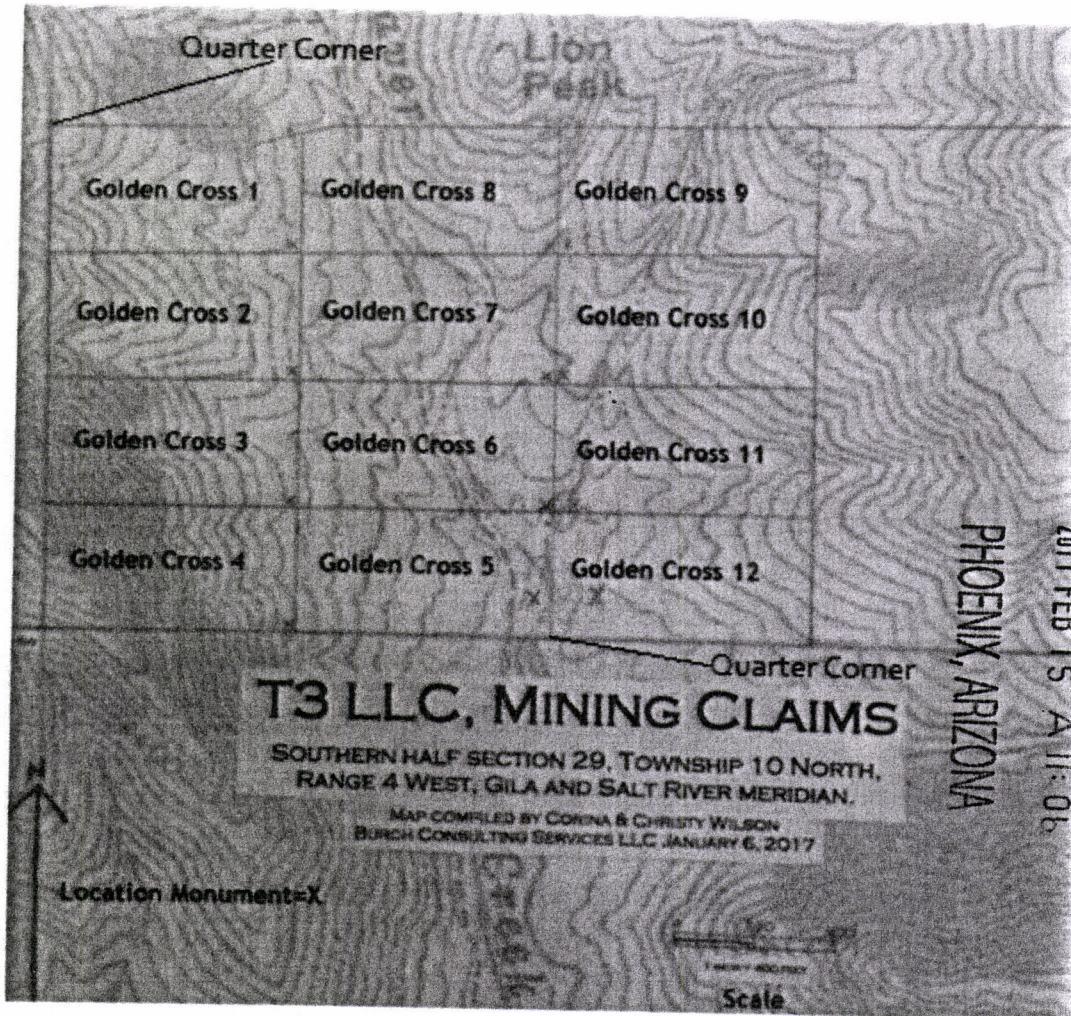

AMC 441705

1. The above map depicts the Golden Cross 2 mining claim, which is located in Section (s) 29, Township 10 North, Range 4 West, Gila and Salt River Base and Meridian, Yavapai County, Arizona. Total claim acreage is 20.

2. The type of corner and location monuments used are as follows: 2" diameter PVC posts

3. The bearings and distances in degrees and feet between claim corners and to a public land survey monument are as depicted on the map.

4. If the claim is a placer or mill site claim with exterior limits conforming to legal subdivisions of the public survey, provide a legal description of the claim: 5 1/2 Lot 7, Sec 29, T.10 N., R.4 W OF G&SRM

Form MCF100a  
Revised July 2014

This form is available from the Arizona Geology Survey and may be reproduced.



Return to \*

LOCATION NOTICE FOR PLACER MINING CLAIM

☐ Amendment BLM Serial # \_\_\_\_\_

NOTICE IS HEREBY GIVEN that the Golden Cross 3

placer mining claim has been located by

T3 LLC whose current mailing

\* address is 1111 East 12<sup>th</sup>  
Harper, Kansas 67058

BLM  
Date  
Stamp

RECEIVED  
BLM STATE OFFICE  
PHOENIX, ARIZONA

2017 FEB 15 A 11:06

The general course of this claim is East-West and it is situated in Yavapai  
County, Arizona. This claim is 1320 feet in length and 660 feet in width.

20 Total Claim Acreage. This claim runs from the location monument on which this location notice is  
posted at the SE corner of the claim approximately 660 feet in a North direction to the  
North end line and 1320 feet in a West direction to the West end line. This claim is  
marked by 5 monuments, a location monument and one at each angle on the boundary of the claim.

The location monument on which this notice is posted is situated within Section 29, Township  
10 North Range 4 West, Gila Salt River Base and Meridian, Arizona. This claim encompasses

portions of the following legal subdivision(s) if located by legal subdivision or the following quarter section(s),  
section(s), Township(s) and Range(s) N 1/2 SW 1/4 SW 1/4, Sec 29,  
T. 10 N., R. 4 W., Gila Salt River Base and Meridian, Arizona.

The locality of this claim with reference to some natural object or permanent monument and additional information

(if any) concerning its locality are as follows: NW Corner of the Mining Claim  
is 1320 feet. S. 0° 02' E, of the West quarter  
Corner of Sec. 29

The above information is shown on the attached map.

DATED AND POSTED on the ground this 18<sup>th</sup> day of January, 20 17.

☒ LOCATOR(s) ☐ AGENT

Print Name(s) NELSON TUCKER STAN TUCKER Brenda Shue  
Signature(s) Nelson Tucker Stan Tucker Brenda Shue

Form MCF102  
Revised July 2014

This form is available from the Arizona Geological Survey and may be reproduced.

AMC441706



**MINING CLAIM MAP**  
Lode ( ) Placer (✓) Millsite ( )

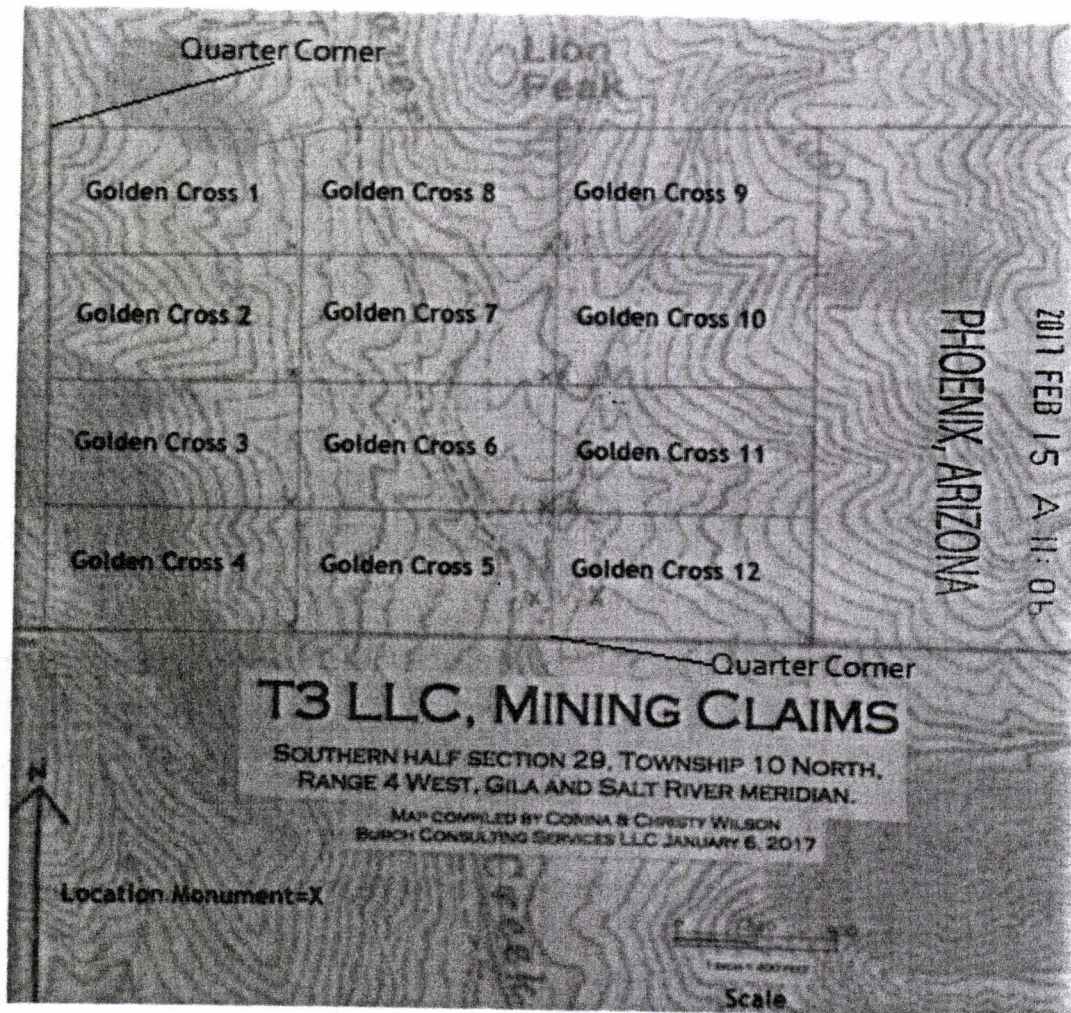

RECEIVED  
BLM AZ STATE OFFICE

2017 FEB 15 A 11:06

PHOENIX, ARIZONA

AMC 441706

1. The above map depicts the Golden Cross 3 mining claim, which is located in Section (s) 29, Township 10 North, Range 4 West, Gila and Salt River Base and Meridian, Yavapai County, Arizona. Total claim acreage is 20.
2. The type of corner and location monuments used are as follows: 2" diameter PVC posts
3. The bearings and distances in degrees and feet between claim corners and to a public land survey monument are as depicted on the map.
4. If the claim is a placer or mill site claim with exterior limits conforming to legal subdivisions of the public survey, provide a legal description of the claim: N 1/2 SW 1/4 SW 1/4, Sec 29, T.10 N., R. 4W G & S R M

Form MCF100a  
Revised July 2014

This form is available from the Arizona Geology Survey and may be reproduced.



Return to \*

LOCATION NOTICE FOR PLACER MINING CLAIM

☐ Amendment BLM Serial # \_\_\_\_\_

NOTICE IS HEREBY GIVEN that the Golden Cross 4

\_\_\_\_\_ placer mining claim has been located by

T3 LLC

whose current mailing

address is 1111 East 12<sup>th</sup>

Harper, Kansas 67058

The general course of this claim is East-West and it is situated in Yavapai County, Arizona. This claim is 1320 feet in length and 660 feet in width.

20 Total Claim Acreage. This claim runs from the location monument on which this location notice is posted at the SE corner of the claim approximately 660 feet in a North direction to the North end line and 1320 feet in a West direction to the West end line. This claim is marked by \_\_\_\_\_ monuments, a location monument and one at each angle on the boundary of the claim.

The location monument on which this notice is posted is situated within Section 29, Township 10 North, Range 4 West, Gila Salt River Base and Meridian, Arizona. This claim encompasses portions of the following legal subdivision(s) if located by legal subdivision or the following quarter section(s), section(s), Township(s) and Range(s) S 1/2 SW 1/4 SW 1/4, Sec. 29, T.10 N., R. 4 W., Gila Salt River Base and Meridian, Arizona.

The locality of this claim with reference to some natural object or permanent monument and additional information (if any) concerning its locality are as follows: SE Corner of the Mining Claim, is 1320 feet West of the South quarter Corner of Sec. 29. The above information is shown on the attached map.

DATED AND POSTED on the ground this 18<sup>th</sup> day of January, 2017.

☒ LOCATOR(s) ☐ AGENT

Print Name(s) NELSON TUCKER Stan Tucker Brenda Shue  
Signature(s) Nelson Tucker Stan Tucker Brenda Shue

Form MCF102  
Revised July 2014

This form is available from the Arizona Geological Survey and may be reproduced.

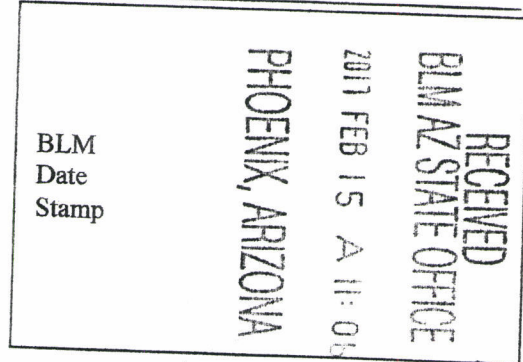

AMC441707



**MINING CLAIM MAP**  
Lode ( ) Placer (x) Millsite ( )

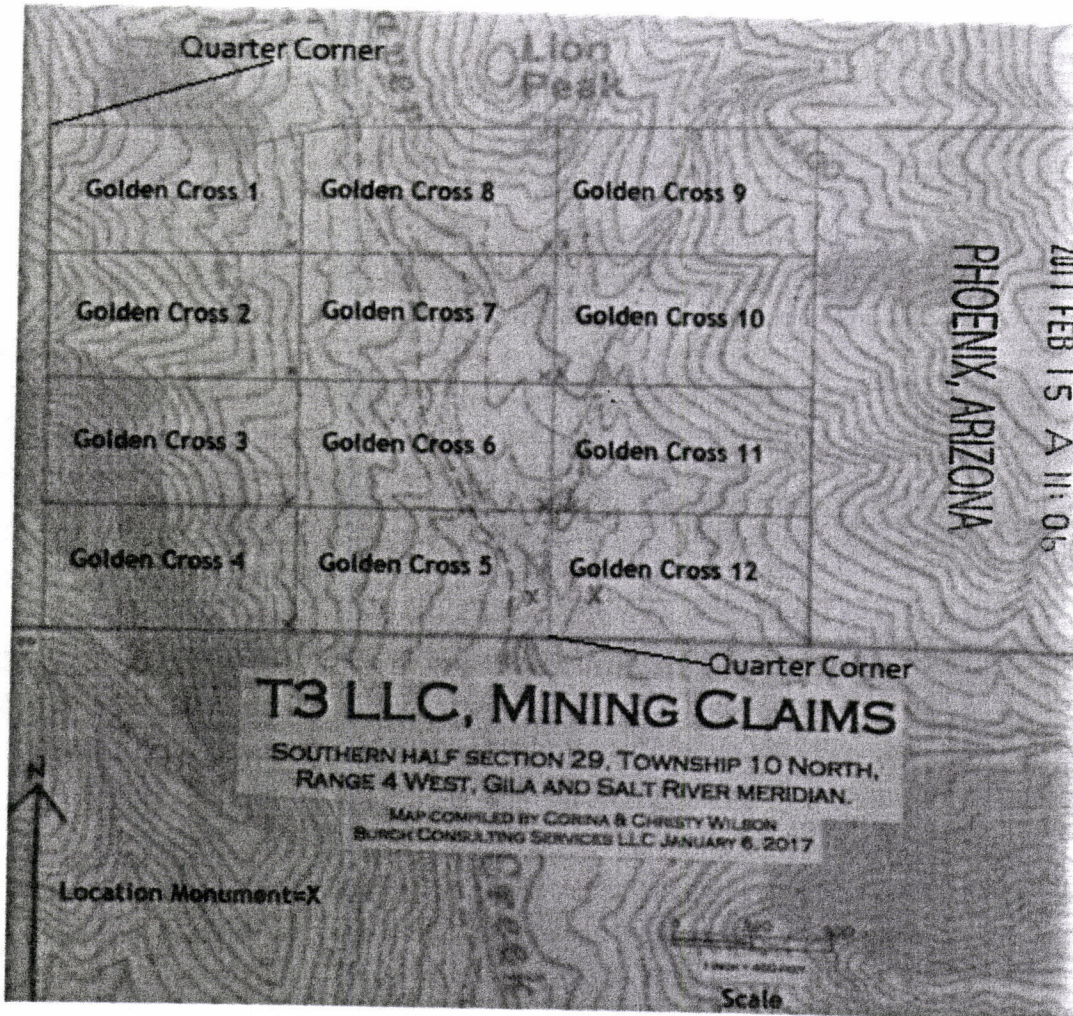

RECEIVED  
BLM AZ STATE OFFICE

2011 FEB 15 A 11:06

PHOENIX, ARIZONA

AMC441707

1. The above map depicts the Golden Cross 4 mining claim, which is located in Section (s) 29, Township 10 North, Range 4 West, Gila and Salt River Base and Meridian, Yavapai County, Arizona. Total claim acreage is 20.
2. The type of corner and location monuments used are as follows: 2" diameter PVC posts
3. The bearings and distances in degrees and feet between claim corners and to a public land survey monument are as depicted on the map.
4. If the claim is a placer or mill site claim with exterior limits conforming to legal subdivisions of the public survey, provide a legal description of the claim: SW 1/2 SW 1/4 SW 1/4, Sec 29, T. 10 N., R. 4 W. G & S Rm

Form MCF100a  
Revised July 2014

This form is available from the Arizona Geology Survey and may be reproduced.



Return to



LOCATION NOTICE FOR PLACER MINING CLAIM

☐ Amendment BLM Serial #

NOTICE IS HEREBY GIVEN that the Golden Cross 5

placer mining claim has been located by

\* T3 LLC whose current mailing

address is 1111 East 12th

Harper, Kansas 67058

The general course of this claim is East-West and it is situated in Yavapai  
County, Arizona. This claim is 1320 feet in length and 660 feet in width.

20 Total Claim Acreage. This claim runs from the location monument on which this location notice is  
posted at the SE corner of the claim approximately 660 feet in a North direction to the  
North end line and 1320 feet in a West direction to the West end line. This claim is  
marked by 5 monuments, a location monument and one at each angle on the boundary of the claim.

The location monument on which this notice is posted is situated within Section 29, Township  
10 North, Range 4 West, Gila Salt River Base and Meridian, Arizona. This claim encompasses

portions of the following legal subdivision(s) if located by legal subdivision or the following quarter section(s),  
section(s), Township(s) and Range(s) S 1/2 SE 1/4 SW 1/4 Sec. 29,

T.10 N., R.4 W., Gila Salt River Base and Meridian, Arizona.

The locality of this claim with reference to some natural object or permanent monument and additional information  
(if any) concerning its locality are as follows: SE Corner of the mining claim

is the South quarter corner of Sec. 29

The above information is shown on the attached map.

DATED AND POSTED on the ground this 18th day of January, 2017.

☒ LOCATOR(s) ☐ AGENT

Print Name(s) NELSON TUCKER

Stan Tucker

Brenda Shue

Signature(s) Nelson Tucker

Stan Tucker

Brenda Shue

Form MCF102  
Revised July 2014

This form is available from the Arizona Geological Survey and may be reproduced.

AMC441708



**MINING CLAIM MAP**  
Lode ( ) Placer (✓) Millsite ( )

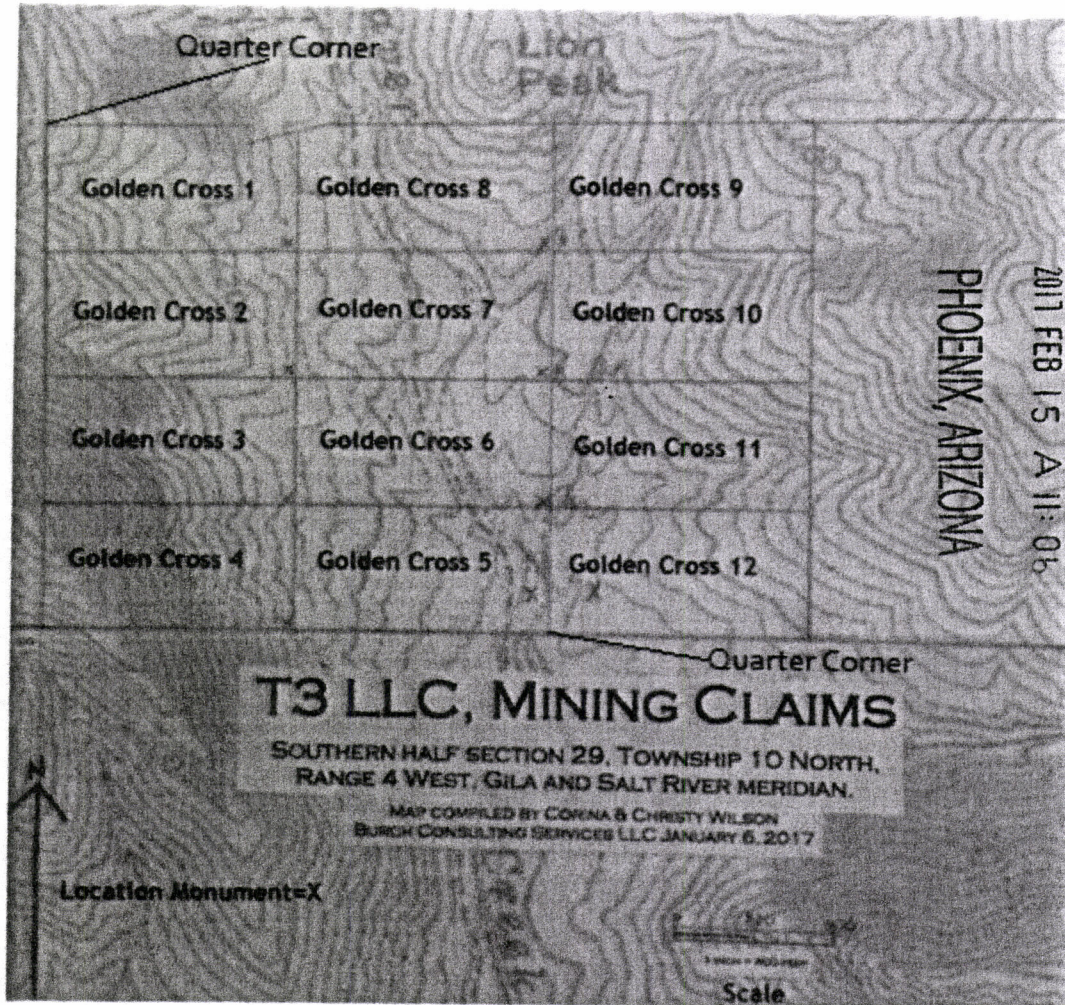

RECEIVED  
BLM AZ STATE OFFICE

2017 FEB 15 A 11:06

PHOENIX, ARIZONA

AMC441708

1. The above map depicts the Golden Cross 5 mining claim, which is located in Section (s) 29, Township 10 North, Range 4 West, Gila and Salt River Base and Meridian, Yavapai County, Arizona. Total claim acreage is 2.0.
2. The type of corner and location monuments used are as follows: 2" diameter PVC posts
3. The bearings and distances in degrees and feet between claim corners and to a public land survey monument are as depicted on the map.
4. If the claim is a placer or mill site claim with exterior limits conforming to legal subdivisions of the public survey, provide a legal description of the claim: 5 1/2 SE 1/4 SW 1/4, Sec 29, T.10 N., R.4W G & SRM

Form MCF100a  
Revised July 2014

This form is available from the **Arizona Geology Survey** and may be reproduced.



Return to \*

**LOCATION NOTICE FOR PLACER MINING CLAIM**

☐ Amendment BLM Serial # \_\_\_\_\_

NOTICE IS HEREBY GIVEN that the Golden Cross 6

placer mining claim has been located by

\* T3 LLC whose current mailing

address is 1111 East 12<sup>th</sup>

Harper, Kansas 67058

The general course of this claim is East-West and it is situated in Yavapai  
County, Arizona. This claim is 1320 feet in length and 660 feet in width.

20 Total Claim Acreage. This claim runs from the location monument on which this location notice is  
posted at the SE corner of the claim approximately 660 feet in a North direction to the  
North end line and 1320 feet in a West direction to the West end line. This claim is  
marked by 5 monuments, a location monument and one at each angle on the boundary of the claim.

The location monument on which this notice is posted is situated within Section 29, Township  
10 North Range 4 West, Gila Salt River Base and Meridian, Arizona. This claim encompasses

portions of the following legal subdivision(s) if located by legal subdivision or the following quarter section(s),  
section(s), Township(s) and Range(s) N 1/2 SE 1/4 SW 1/4, Sec. 29,  
T. 10 N., R. 4 W., Gila Salt River Base and Meridian, Arizona.

The locality of this claim with reference to some natural object or permanent monument and additional information  
(if any) concerning its locality are as follows: SE Corner of the Mining Claim  
is 660 feet N. 0° 02' W. of the South quarter  
Corner of Sec. 29 The above information is shown on the attached map.

DATED AND POSTED on the ground this 18<sup>th</sup> day of January, 2017.

☒ LOCATOR(s) ☐ AGENT

Print Name(s) NELSON TUCKER Stan Tucker Brenda Shue  
Signature(s) Nelson Tucker Stan Tucker Brenda Shue

Form MCF102  
Revised July 2014

This form is available from the Arizona Geological Survey and may be reproduced.

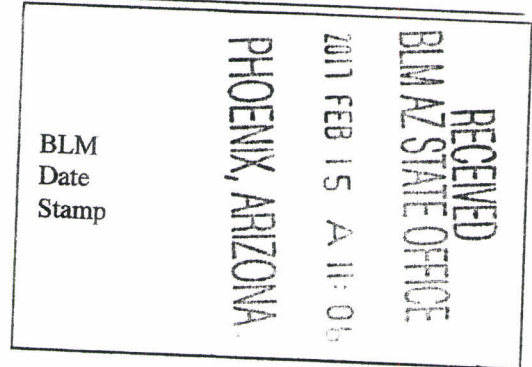

AMC441709



**MINING CLAIM MAP**  
Lode ( ) Placer (x) Millsite ( )

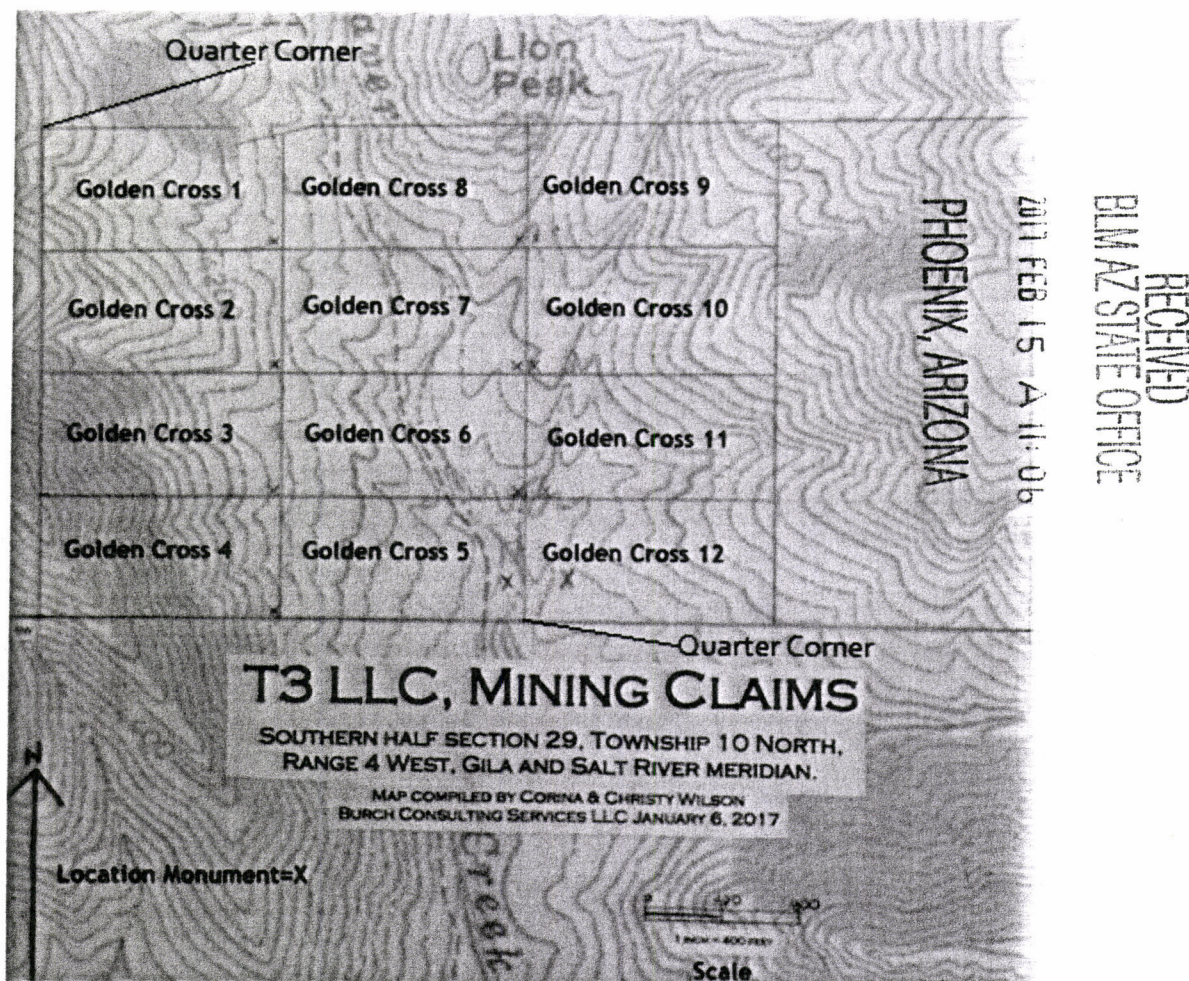

1. The above map depicts the Golden Cross 6 mining claim, which is located in Section (s) 29, Township 10 North, Range 4 West, Gila and Salt River Base and Meridian, Yavapai County, Arizona. Total claim acreage is 20.
2. The type of corner and location monuments used are as follows: 2" diameter PVC posts
3. The bearings and distances in degrees and feet between claim corners and to a public land survey monument are as depicted on the map.
4. If the claim is a placer or mill site claim with exterior limits conforming to legal subdivisions of the public survey, provide a legal description of the claim: N 1/2 SE 1/4 SW 1/4, Sec. 29, T.10 N., R.4 W., G & SRM

Form MCF100a  
Revised July 2014

This form is available from the Arizona Geology Survey and may be reproduced.



Return to \*

**LOCATION NOTICE FOR PLACER MINING CLAIM**

☐ Amendment BLM Serial # \_\_\_\_\_

NOTICE IS HEREBY GIVEN that the Golden Cross 7

placer mining claim has been located by

\* T3 LLC whose current mailing

address is 1111 East 12<sup>th</sup>

Harper, Kansas 67058

The general course of this claim is East-West and it is situated in Yavapai  
County, Arizona. This claim is 1320 feet in length and 660 feet in width.

20 Total Claim Acreage. This claim runs from the location monument on which this location notice is

posted at the SE corner of the claim approximately 660 feet in a North direction to the

North end line and 1320 feet in a West direction to the West end line. This claim is

marked by 5 monuments, a location monument and one at each angle on the boundary of the claim.

The location monument on which this notice is posted is situated within Section 29, Township

10 North Range 4 West, Gila Salt River Base and Meridian, Arizona. This claim encompasses

portions of the following legal subdivision(s) if located by legal subdivision or the following quarter section(s),

section(s), Township(s) and Range(s) 5 1/2 of Lot 6, Sec 29,

T. 10 N., R. 4 W, Gila Salt River Base and Meridian, Arizona.

The locality of this claim with reference to some natural object or permanent monument and additional information

(if any) concerning its locality are as follows: SE Corner of the mining claim  
is 1320 feet N. 0° 02' W. of the South Quarter  
Corner of Sec. 29

The above information is shown on the attached map.

DATED AND POSTED on the ground this 18<sup>th</sup> day of January, 2017.

☒ LOCATOR(s) ☐ AGENT

Print Name(s) NELSON TUCKER Stan Tucker Brenda Shue

Signature(s) Nelson Tucker Stan Tucker Brenda Shue

Form MCF102  
Revised July 2014

This form is available from the Arizona Geological Survey and may be reproduced.

AMC441710

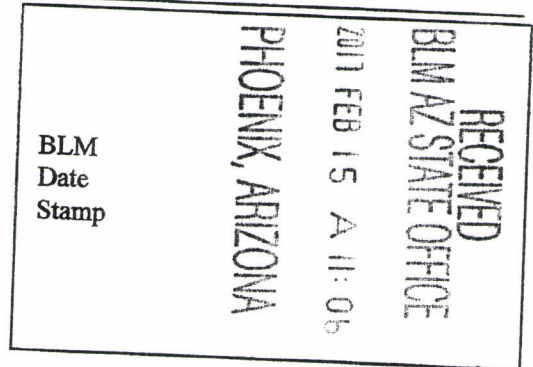



**MINING CLAIM MAP**  
Lode ( ) Placer (x) Millsite ( )

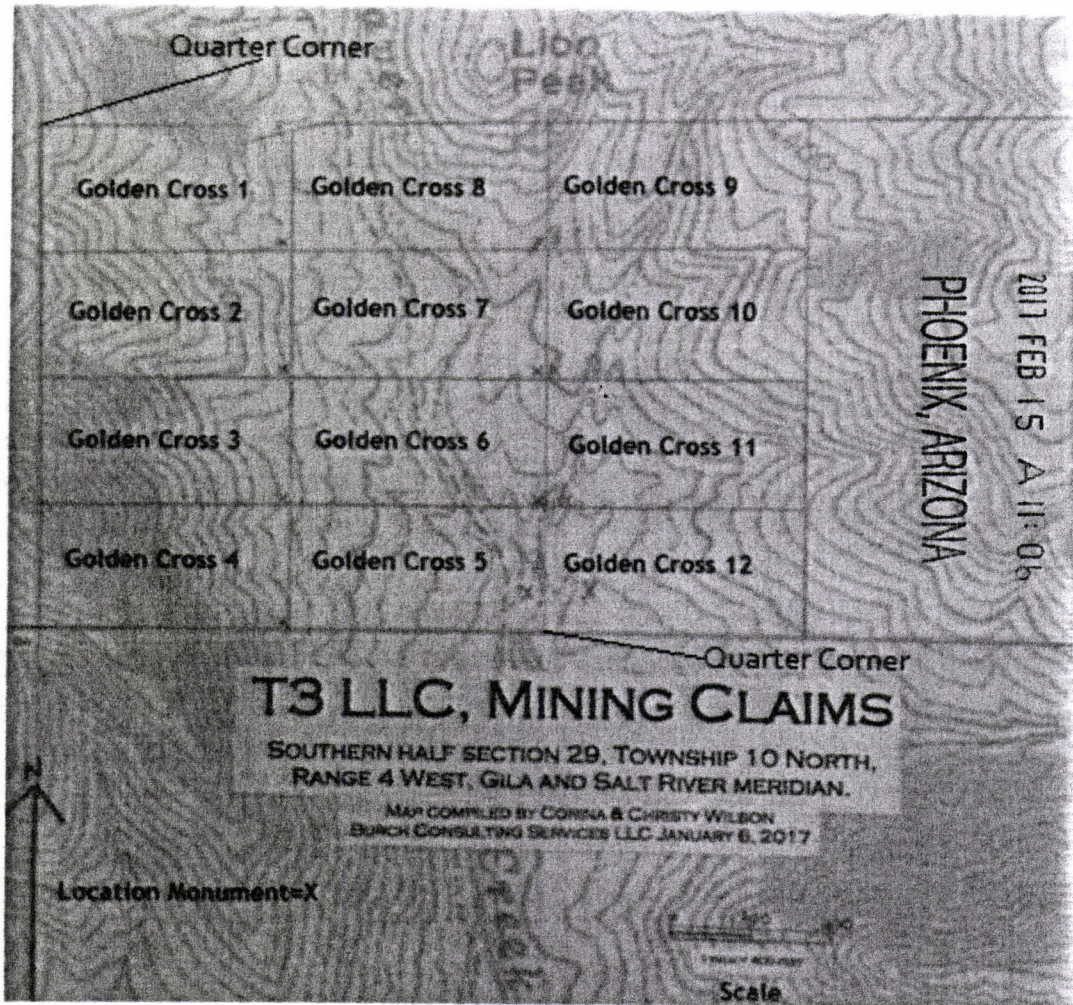

PHOENIX, ARIZONA

2017 FEB 15 A 11:06

RECEIVED  
BIMAZ STATE OFFICE

AMC441710

1. The above map depicts the Golden Cross 7 mining claim, which is located in Section (s) 29, Township 10 North, Range 4 West, Gila and Salt River Base and Meridian, Yavapai County, Arizona. Total claim acreage is 2.0.
2. The type of corner and location monuments used are as follows: 2" diameter PVC posts
3. The bearings and distances in degrees and feet between claim corners and to a public land survey monument are as depicted on the map.
4. If the claim is a placer or mill site claim with exterior limits conforming to legal subdivisions of the public survey, provide a legal description of the claim: S 1/2 Lot 6, Sec 29, T. 10 N. R. 4 W G & SRM

Form MCF100a  
Revised July 2014

This form is available from the Arizona Geology Survey and may be reproduced.



Return to \*



**LOCATION NOTICE FOR PLACER MINING CLAIM**

☐ Amendment BLM Serial # \_\_\_\_\_

NOTICE IS HEREBY GIVEN that the Golden Cross 8

placer mining claim has been located by

\* T3 LLC whose current mailing

address is 1111 East 12<sup>th</sup>

Harper, Kansas 67058

The general course of this claim is East-West and it is situated in Yavapai  
County, Arizona. This claim is 1320 feet in length and 660 feet in width.

19.81 Total Claim Acreage. This claim runs from the location monument on which this location notice is

posted at the SE corner of the claim approximately 660 feet in a North direction to the

North end line and 1320 feet in a West direction to the West end line. This claim is

marked by 10 monuments, a location monument and one at each angle on the boundary of the claim.

The location monument on which this notice is posted is situated within Section 29, Township

10 North, Range 4 West, Gila Salt River Base and Meridian, Arizona. This claim encompasses

portions of the following legal subdivision(s) if located by legal subdivision or the following quarter section(s),

section(s), Township(s) and Range(s) N 1/2 Lot 6, Sec 29, T. 10

N. 1/4 R. 4 W., Gila Salt River Base and Meridian, Arizona.

The locality of this claim with reference to some natural object or permanent monument and additional information

(if any) concerning its locality are as follows: SE Corner of the mining claim

is 1980 feet N.D° 02' W. of the South Quarter

Corner of Sec. 29 The above information is shown on the attached map.

DATED AND POSTED on the ground this 18<sup>th</sup> day of January, 2017.

☒ LOCATOR(s) ☐ AGENT

Print Name(s) NELSON TUCKER Stan Tucker Brenda Shue

Signature(s) Nelson Tucker Stan Tucker Brenda Shue

Form MCF102  
Revised July 2014

This form is available from the Arizona Geological Survey and may be reproduced.

AMC441711



**MINING CLAIM MAP**  
Lode ( ) Placer (✓) Millsite ( )

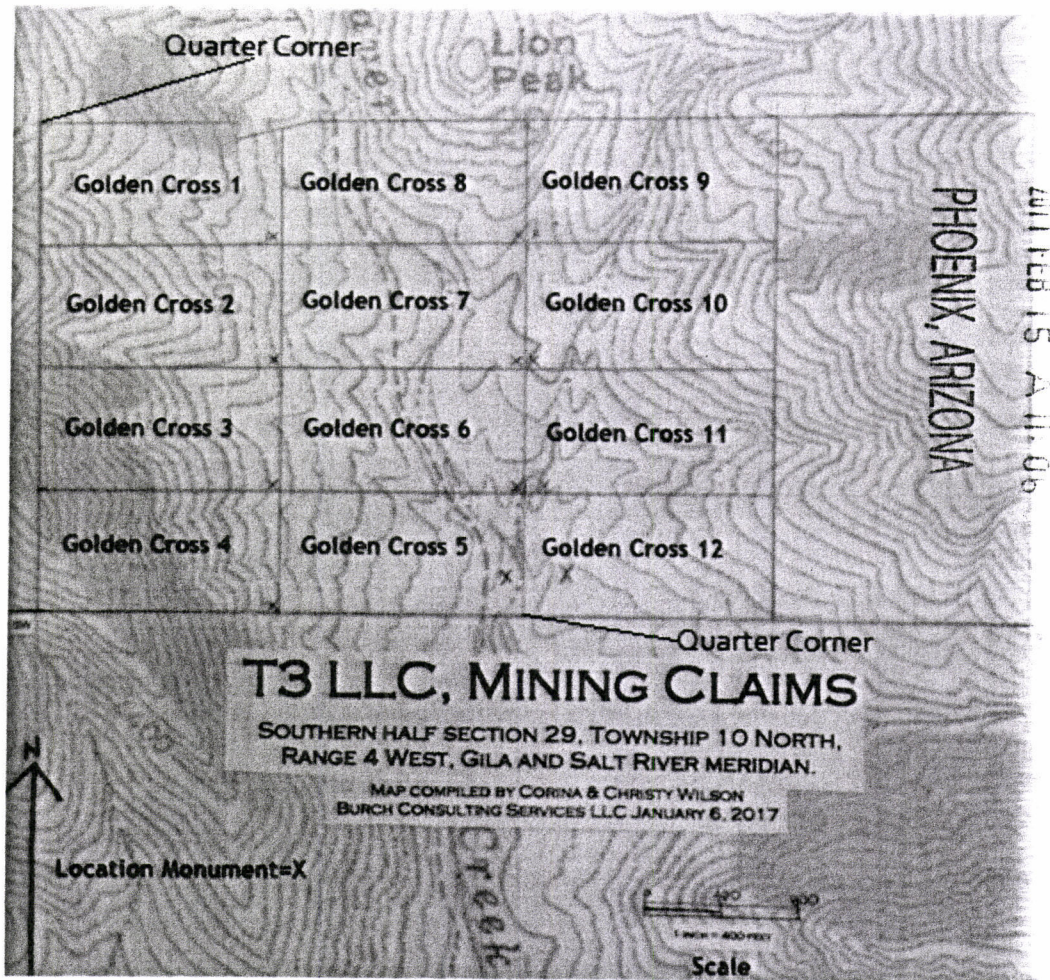

1. The above map depicts the Golden Cross 8 mining claim, which is located in Section (s) 29, Township 10 North, Range 4 West, Gila and Salt River Base and Meridian, \_\_\_\_\_ County, Arizona. Total claim acreage is 19.81.
2. The type of corner and location monuments used are as follows: 2" Diameter PVC posts
3. The bearings and distances in degrees and feet between claim corners and to a public land survey monument are as depicted on the map.
4. If the claim is a placer or mill site claim with exterior limits conforming to legal subdivisions of the public survey, provide a legal description of the claim: N 1/2 Lot 6, Sec 29, T.10 N., R.4 W., G & S R M

**Form MCF100a**  
Revised July 2014

This form is available from the **Arizona Geology Survey** and may be reproduced.

AMC441711





Return to \*

LOCATION NOTICE FOR PLACER MINING CLAIM

☐ Amendment BLM Serial # \_\_\_\_\_

NOTICE IS HEREBY GIVEN that the Golden Cross 9

\_\_\_\_\_ placer mining claim has been located by

\* T3 LLC whose current mailing

address is 1111 East 12th

Harper, Kansas 67058

The general course of this claim is East-West and it is situated in Yavapai County, Arizona. This claim is 1320 feet in length and 1660 feet in width.

20 Total Claim Acreage. This claim runs from the location monument on which this location notice is posted at the SW corner of the claim approximately 1660 feet in a North direction to the North end line and 1320 feet in a East direction to the East end line. This claim is marked by 5 monuments, a location monument and one at each angle on the boundary of the claim.

The location monument on which this notice is posted is situated within Section 29, Township 10 North, Range 4 West, Gila Salt River Base and Meridian, Arizona. This claim encompasses

portions of the following legal subdivision(s) if located by legal subdivision or the following quarter section(s), section(s), Township(s) and Range(s) N 1/2 NW 1/4 SE 1/4, Sec 29,

T.10 N., R.4 W., Gila Salt River Base and Meridian, Arizona.

The locality of this claim with reference to some natural object or permanent monument and additional information (if any) concerning its locality are as follows: SW Corner of the Mining Claim

is 1980 feet N. 0° 02' W. of the South quarter  
Corner of Sec. 29 The above information is shown on the attached map.

DATED AND POSTED on the ground this 18th day of January, 2017.

☒ LOCATOR(s) ☐ AGENT

Print Name(s) NELSON TUCKER STAN TUCKER Brenda Shue  
Signature(s) Nelson Tucker Stan Tucker Brenda Shue

Form MCF102  
Revised July 2014

This form is available from the Arizona Geological Survey and may be reproduced.

AMC441712



**MINING CLAIM MAP**  
Lode ( ) Placer (x) Millsite ( )

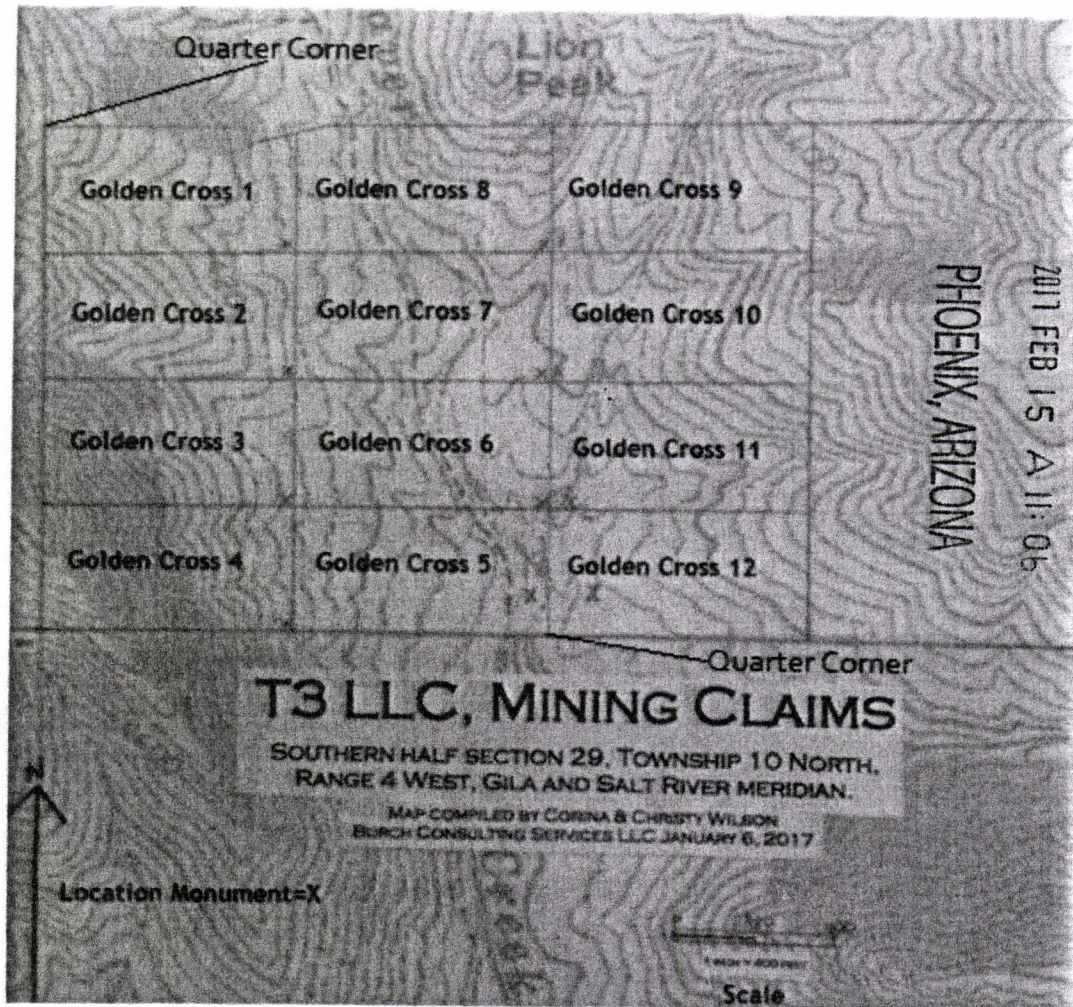

AMC 441712

1. The above map depicts the Golden Cross 9 mining claim, which is located in Section (s) 29, Township 10 North, Range 4 West, Gila and Salt River Base and Meridian, Yavapai County, Arizona. Total claim acreage is 20.
2. The type of corner and location monuments used are as follows: 2" diameter PVC posts
3. The bearings and distances in degrees and feet between claim corners and to a public land survey monument are as depicted on the map.
4. If the claim is a placer or mill site claim with exterior limits conforming to legal subdivisions of the public survey, provide a legal description of the claim: N 1/2 NW 1/4 SE 1/4, Sec. 29, T10 N., R. 4 W., G & S R M

Form MCF100a  
Revised July 2014

This form is available from the Arizona Geology Survey and may be reproduced.



Return to \*



LOCATION NOTICE FOR PLACER MINING CLAIM

☐ Amendment BLM Serial # \_\_\_\_\_

NOTICE IS HEREBY GIVEN that the Golden Cross 10

\_\_\_\_\_ placer mining claim has been located by

\* T3 LLC whose current mailing

address is 1111 East 12th

Harper, Kansas 67058

BLM  
Date  
Stamp

PHOENIX, ARIZONA

FEB 15 4 11:06

BLM AZ STATE OFFICE

RECEIVED

The general course of this claim is East-West and it is situated in Yavapai County, Arizona. This claim is 1320 feet in length and 1660 feet in width.

20 Total Claim Acreage. This claim runs from the location monument on which this location notice is

posted at the SW corner of the claim approximately 1660 feet in a North direction to the

North end line and 1320 feet in a East direction to the East end line. This claim is

marked by 5 monuments, a location monument and one at each angle on the boundary of the claim.

The location monument on which this notice is posted is situated within Section 29, Township

10 North, Range 4 West, Gila Salt River Base and Meridian, Arizona. This claim encompasses

portions of the following legal subdivision(s) if located by legal subdivision or the following quarter section(s),

section(s), Township(s) and Range(s) S 1/2 of NW 1/4 SE 1/4, Sec 29

10. N., R. 4 W., Gila Salt River Base and Meridian, Arizona.

The locality of this claim with reference to some natural object or permanent monument and additional information

(if any) concerning its locality are as follows: SW corner of the mining claim

is 1320 feet N. 0° 02' W. of the South quarter

corner of Sec. 29 The above information is shown on the attached map.

DATED AND POSTED on the ground this 18th day of January, 2017.

☒ LOCATOR(s) ☐ AGENT

Print Name(s) NELSON TUCKER

Signature(s) Nelson Tucker Stan Tucker Brenda Shue  
Nelson Tucker Stan Tucker Brenda Shue

Form MCF102  
Revised July 2014

This form is available from the Arizona Geological Survey and may be reproduced.

AMC441713



**MINING CLAIM MAP**  
Lode ( ) Placer (✓) Millsite ( )

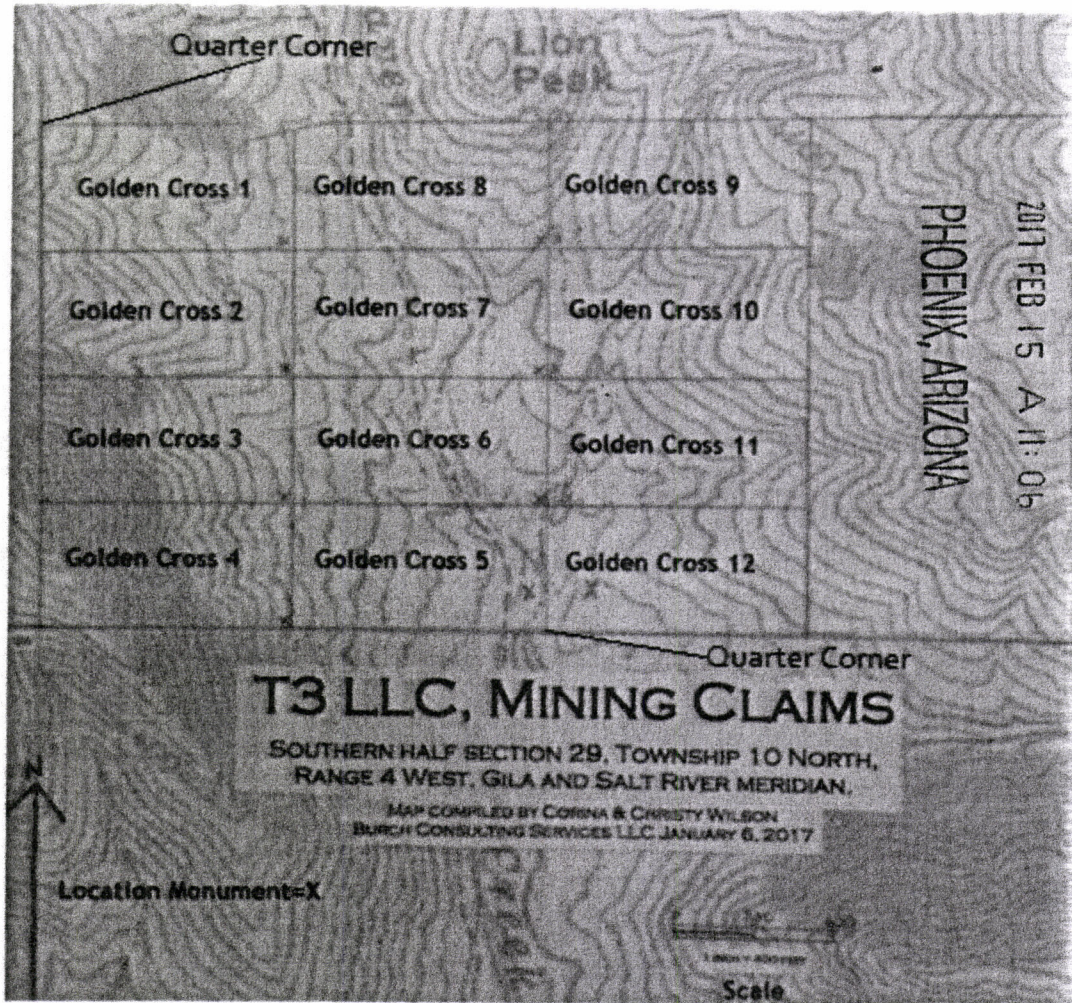

RECEIVED  
BIMAZ STATE OFFICE

PHOENIX, ARIZONA

2017 FEB 15 A 11:06

AMC441713

1. The above map depicts the Golden Cross 10 mining claim, which is located in Section (s) 29, Township 10 North, Range 4 West, Gila and Salt River Base and Meridian, Yavapai County, Arizona. Total claim acreage is 2.0.

2. The type of corner and location monuments used are as follows: 2" diameter PVC posts

3. The bearings and distances in degrees and feet between claim corners and to a public land survey monument are as depicted on the map.

4. If the claim is a placer or mill site claim with exterior limits conforming to legal subdivisions of the public survey, provide a legal description of the claim: 5/2 NW 1/4 SE 1/4, Sec. 29 10 N, R. 4 W, G & S R M

Form MCF100a  
Revised July 2014

This form is available from the Arizona Geology Survey and may be reproduced.



Return to \*

**LOCATION NOTICE FOR PLACER MINING CLAIM**

☐ Amendment BLM Serial # \_\_\_\_\_

NOTICE IS HEREBY GIVEN that the Golden Cross II  
\_\_\_\_\_ placer mining claim has been located by

\* T3 LLC whose current mailing

address is 1111 East 12th

Harper, Kansas 67058

The general course of this claim is East-West and it is situated in Yavapai  
County, Arizona. This claim is 1320 feet in length and 1660 feet in width.

20 Total Claim Acreage. This claim runs from the location monument on which this location notice is

posted at the SW corner of the claim approximately 1660 feet in a North direction to the

North end line and 1320 feet in a East direction to the East end line. This claim is  
marked by 5 monuments, a location monument and one at each angle on the boundary of the claim.

The location monument on which this notice is posted is situated within Section 29, Township  
10 North, Range 4 West, Gila Salt River Base and Meridian, Arizona. This claim encompasses

portions of the following legal subdivision(s) if located by legal subdivision or the following quarter section(s),

section(s), Township(s) and Range(s) N 1/2 SW 1/4 SE 1/4, Sec 29  
T.10 N, R. 4 W

\_\_\_\_\_, Gila Salt River Base and Meridian, Arizona.

The locality of this claim with reference to some natural object or permanent monument and additional information

(if any) concerning its locality are as follows: SW Corner of the mining claim  
is 1660 feet N. 0° 02' W. of the South  
quarter of Sec. 29

The above information is shown on the attached map.

DATED AND POSTED on the ground this 18th day of January, 2017.

☒ LOCATOR(s) ☐ AGENT

Print Name(s) NELSON TUCKER

Signature(s) Nelson Tucker Stan Tucker Brenda Shue  
Stan Tucker Brenda Shue

Form MCF102  
Revised July 2014

This form is available from the Arizona Geological Survey and may be reproduced.

AMC441714

BLM  
Date  
Stamp

PHOENIX, ARIZONA

2017 FEB 15 A 11:06

BLM AZ STATE OFFICE

RECEIVED



**MINING CLAIM MAP**  
Lode ( ) Placer (x) Millsite ( )

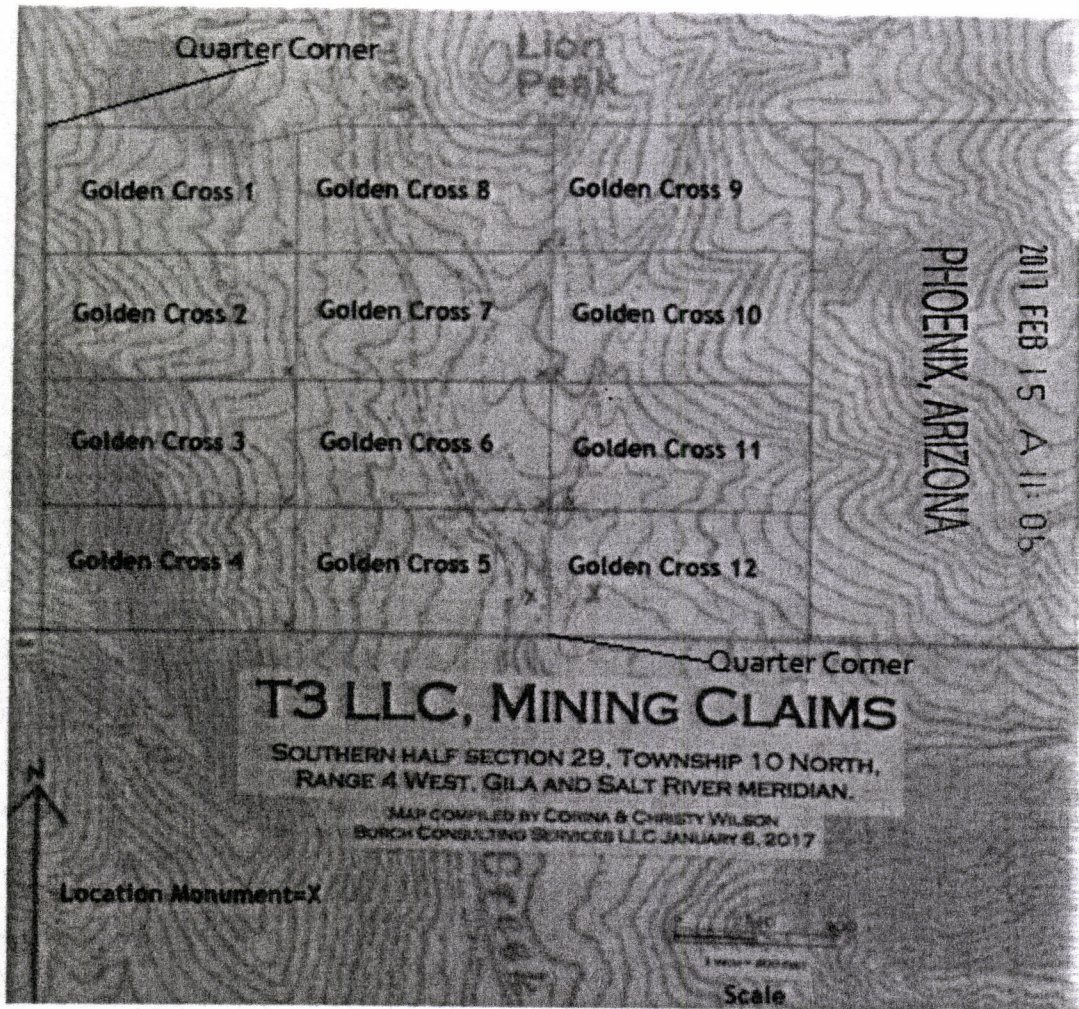

AMC441714

1. The above map depicts the Golden Cross 11 mining claim, which is located in Section (s) 29, Township 10 North, Range 4 West, Gila and Salt River Base and Meridian, Yavapai County, Arizona. Total claim acreage is 20.
2. The type of corner and location monuments used are as follows: 2" diameter PVC posts
3. The bearings and distances in degrees and feet between claim corners and to a public land survey monument are as depicted on the map.
4. If the claim is a placer or mill site claim with exterior limits conforming to legal subdivisions of the public survey, provide a legal description of the claim: N 1/2 SW 1/4 SE 1/4, Sec 29 T.10N, R.4W, G & SRM

Form MCF100a  
Revised July 2014

This form is available from the Arizona Geology Survey and may be reproduced.



Return to \*



LOCATION NOTICE FOR PLACER MINING CLAIM

☐ Amendment BLM Serial # \_\_\_\_\_

NOTICE IS HEREBY GIVEN that the Golden Cross 12

placer mining claim has been located by

\*T3 LLC

whose current mailing

address is 1111 East 12th

Harper, Kansas 67058

The general course of this claim is East-West and it is situated in Yavapai  
County, Arizona. This claim is 1320 feet in length and 1660 feet in width.

20 Total Claim Acreage. This claim runs from the location monument on which this location notice is  
posted at the SW corner of the claim approximately 1660 feet in a North direction to the  
North end line and 1320 feet in a East direction to the East end line. This claim is  
marked by 5 monuments, a location monument and one at each angle on the boundary of the claim.

The location monument on which this notice is posted is situated within Section 29, Township  
10 North, Range 4 West, Gila Salt River Base and Meridian, Arizona. This claim encompasses  
portions of the following legal subdivision(s) if located by legal subdivision or the following quarter section(s),  
section(s), Township(s) and Range(s) SW 1/4 SE 1/4, Sec 29,  
T.10 N., R. 4 W., Gila Salt River Base and Meridian, Arizona.

The locality of this claim with reference to some natural object or permanent monument and additional information  
(if any) concerning its locality are as follows: SW Corner of the mining  
claim is the South quarter corner of Sec. 29

The above information is shown on the attached map.

DATED AND POSTED on the ground this 18th day of January, 2017.

☒ LOCATOR(s) ☐ AGENT

Print Name(s) NELSON TUCKER Stan Tucker Brenda Shue  
Signature(s) Nelson Tucker Stan Tucker Brenda Shue

Form MCF102  
Revised July 2014

This form is available from the Arizona Geological Survey and may be reproduced.

AMC441715



**MINING CLAIM MAP**  
Lode ( ) Placer (x) Millsite ( )

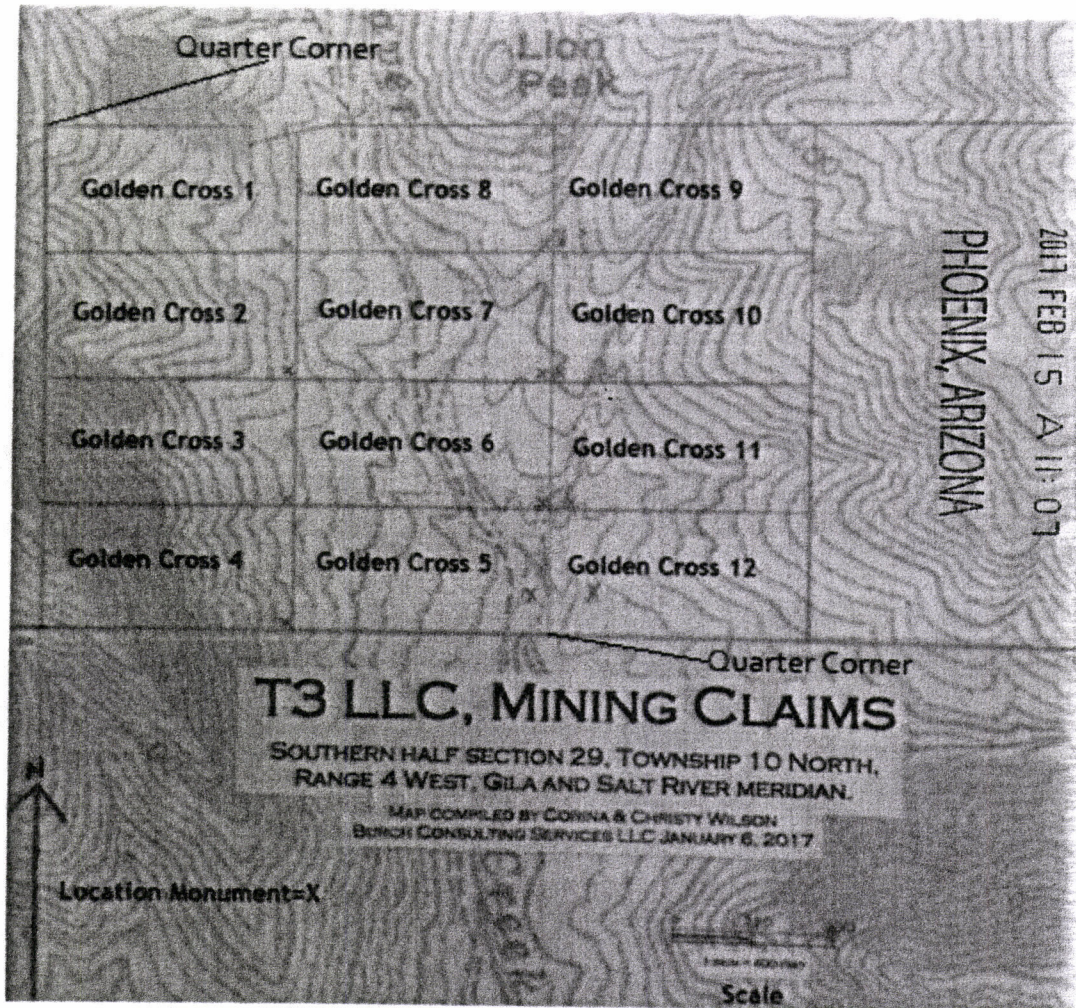

RECEIVED  
BIMAZ STATE OFFICE

2011 FEB 15 A 11:07

PHOENIX, ARIZONA

AMC441715

1. The above map depicts the Golden Cross 12 mining claim, which is located in Section (s) 29, Township 10 North, Range 4 West, Gila and Salt River Base and Meridian, Yavapai County, Arizona. Total claim acreage is 2.0.
2. The type of corner and location monuments used are as follows: 2" diameter PVC posts.
3. The bearings and distances in degrees and feet between claim corners and to a public land survey monument are as depicted on the map.
4. If the claim is a placer or mill site claim with exterior limits conforming to legal subdivisions of the public survey, provide a legal description of the claim: 1/2 SW 1/4 SE 1/4, Sec 29, T.10 N R.4 W.1 G & SRM

Form MCF100a  
Revised July 2014

This form is available from the **Arizona Geology Survey** and may be reproduced.



RUN TIME: 10:52 AM

DEPARTMENT OF INTERIOR  
BUREAU OF LAND MANAGEMENT

RUN DATE: 02/15/2017  
Page 1 of 1

Input Parameters for Geographic Report with Land

System Id = CR

Admin State = AZ

Geo State =

Casetype Begins With

Case Disp Txt = CANCELLED, EXPIRED, PENDING, REJECTED, RELINQUISHED, VOID, WITHDRAWN

Mer Twp Rng = 14 0100N 0040W

Section = 029, 999

Mtrs =

Commodity =

Commodity Txt =

Pending Org =

Pend Org Decode =

Total Rows Returned: 0

NO WARRANTY IS MADE BY BLM FOR USE OF THE DATA  
FOR PURPOSES NOT INTENDED BY BLM



RUN TIME: 10:53 AM

Adm State:

UNITED STATES DEPARTMENT OF INTERIOR  
BUREAU OF LAND MANAGEMENT  
GEOGRAPHIC REPORT WITH LAND  
Sorted by Meridian Township Range

RUN DATE: 02/15/2017  
Page 1 of 1



YAVAPAI COUNTY  
HASSAYAMPA FIELD OFFICE

[illegible]

CURRENT TO	NW	GSR Mer
9-28-2011	ACAD	T 10 N
		R 4 W

